

# Typical Single Family Dwelling with Basement

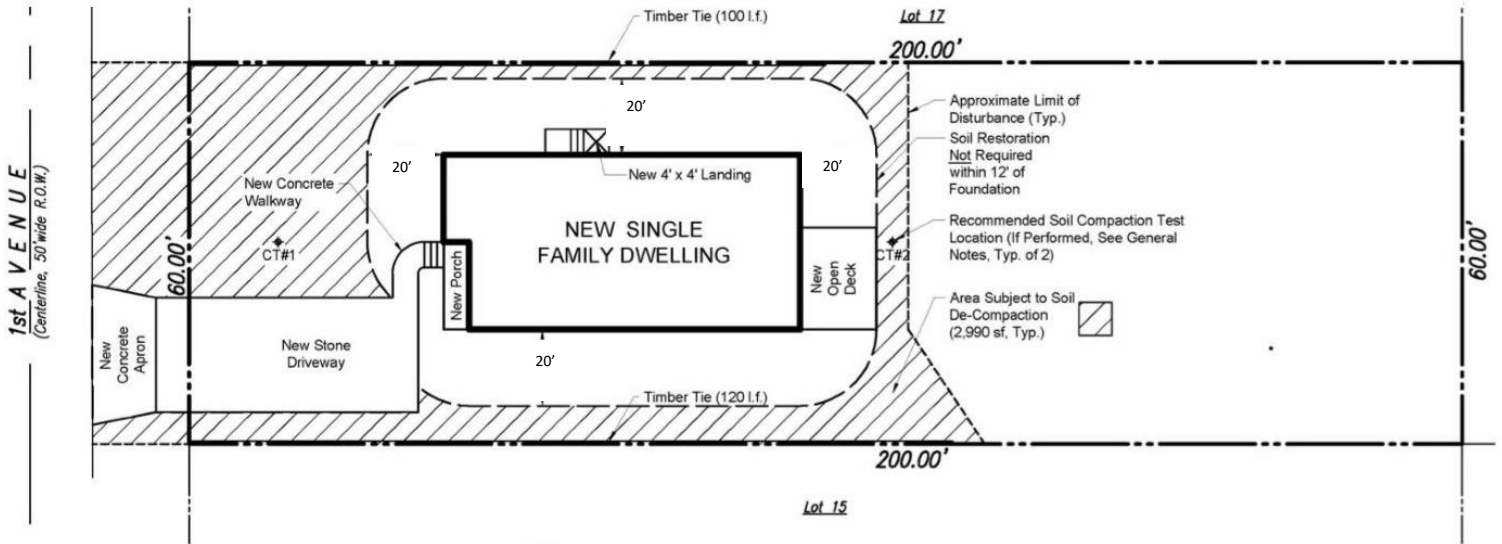

## Soil Compaction Mitigation Plan



### TOPSOIL & SOIL DE-COMPACTION REQUIREMENTS

1. A minimum of 5 inches of topsoil is required on areas to be vegetated to improve the soil medium for plant establishment and maintenance per Chapter 8 of the "Standards for Soil Erosion and Sediment Control in New Jersey" dated July 2017.
2. Subgrade soils shall be free of excessive compaction to a depth of 6 inches to enhance the establishment of permanent vegetative cover per Chapter 19 of the "Standards for Soil Erosion and Sediment Control in New Jersey" dated July 2017.
3. Subsoils are to be proactively de-compacted or soil compaction tested prior to the application of topsoil. Compaction testing method/procedure shall be performed per Chapter 19 by the contractor or other project owner's representative. If the testing indicates subsoil compaction, the subsoil shall be de-compacted to a depth of 6 inches prior to the application of topsoil.
4. If compaction testing is not performed, subsoils shall be scarified/ tilled to a minimum depth of 6 inches as part of the sequence of construction where there is no danger to underground utilities (cables, irrigation systems, etc.). In the alternative, another method as specified by a New Jersey Licensed Professional Engineer maybe substituted subject to District approval.